



TEMPORARY TRAFFIC ORDER - STREETWORKS

(Please complete in full and return to streetworks@gloucestershire.gov.uk)

APPLICANTS DETAILS -

Name: TriConnex Ltd – Purdy Payne

Address: 4 Tamdown Way, Braintree, Essex, CM7 2QL

Contact Number: 01376 332 688

Email: Purdy.payne@triconnex.co.uk

INVOICE DETAILS -

Name and Address for invoice (if different from above):

Contact Number:

Email:

Purchase Order/Ref no for invoice: TRI/X426/00006

INSTRUCTING OFFICER AND TELEPHONE NUMBER -

Traffic Order Details

Road number and local name: C365 Brockworth Road

Closure Location: From: - bridge over A417 To: - Court Rd

Total Distance: - 130m

District – Tewkesbury

Parish Brockworth

Town - Gloucester

Type of Closure/Restriction:

Full Road Closure

Do any other Orders need to be suspended throughout these works? **NO**

Reason for Request: - For safety for site staff and members of the public, road will be closed during the day whilst works are being carried as road is not wide enough to use positive TM

Dates/ Time Required: From: 25/01/2019

Until: 07/02/2019

Is Secretary of State Consent required? **NO**

Proposed Alternative Route

C365 Court Road, Moorfield Road, -C380 Ermin Street, Hucclecote Road, -C 218 Churchdown Lane, Hucclecote Lane – C365 Brockworth Lane

Please confirm that:

Emergency access is to be maintained **YES**

Pedestrian access is to be maintained **YES**

If **NO** to either, please explain why:

Declaration

I, hereby confirm my Authority to act on behalf of the Organisation as described above, and confirm our intent to comply with the Conditions as laid out overleaf.

Applicant Signed:

Dated:

Data Protection Act 1998 (as amended). This information is collected for the administration of Gloucestershire County Council. It may be provided to outside agencies and neighbouring authorities to advise them of the arrangements in place. If you have a query of concern regarding this, please contact the relevant Gloucestershire County Council Stakeholder

Conditions

The applicant must agree to:

1. Meet all the necessary legal, administrative and advertising costs of £1250.00

Plus £150.00 per any additional road on same application

£300.00 for deferral of start date.

£300.00 for any extension to closure date

If the TTRO is cancelled before any adverts are placed a charge of £450.00 will still be made (admin and legal)

2. Maintain pedestrian and emergency access at all times

3. Applicant must erect advanced warning notices (7008) at least 7 days before works commence (to include company name, date, duration and contact number)

4. Erect and maintain signs for the closure and the alternative route

5. Supply a minimum of 12 weeks notice to Gloucestershire County Council

6. Indemnify Gloucestershire County Council against all claims including any third party claims in respect of the closure/restriction and its associated works

7. Meet any additional costs incurred if changes are required to bus routes/timetables.

The only reasons for permitting a road closure/restriction are as follows: -

1. Works are to be executed on or near the highway.

2. Danger to the public or serious damage to the road.

3. Environmental reasons.

Further Notes

Works under a temporary traffic order must commence on the date given overleaf.

If the commencement of works is delayed by up to 7 days, further notices must be erected on site prior to the new commencement date.

If works are delayed between 7 and 28 days a further advertisement may be required. **Contact Gloucestershire County Council for information: -**

08000 514514

If works are delayed more than 28 days from the date of closure then the application process must be restarted giving a further 8 weeks notice.

Any changes to start or finish dates or to other details **MUST** be brought to the attention of the **Gloucestershire County Council**.

Emergency Notices

Emergency Notices *cannot* be given for planned works nor can they be processed in advance. This process must only be used for works that pose a danger to the public.

For Office Use Only

Financial Cost Centre Code: 302719/47700

(Capital, Revenue or recoverable)

Authority for an Order in the above terms given by;

Area Manager/Local Highway Manager (please delete as appropriate)

Paul Cameron (Printed Name) Paul Cameron

Co-ordinator [Signature]

Date of Authority 10/11/18

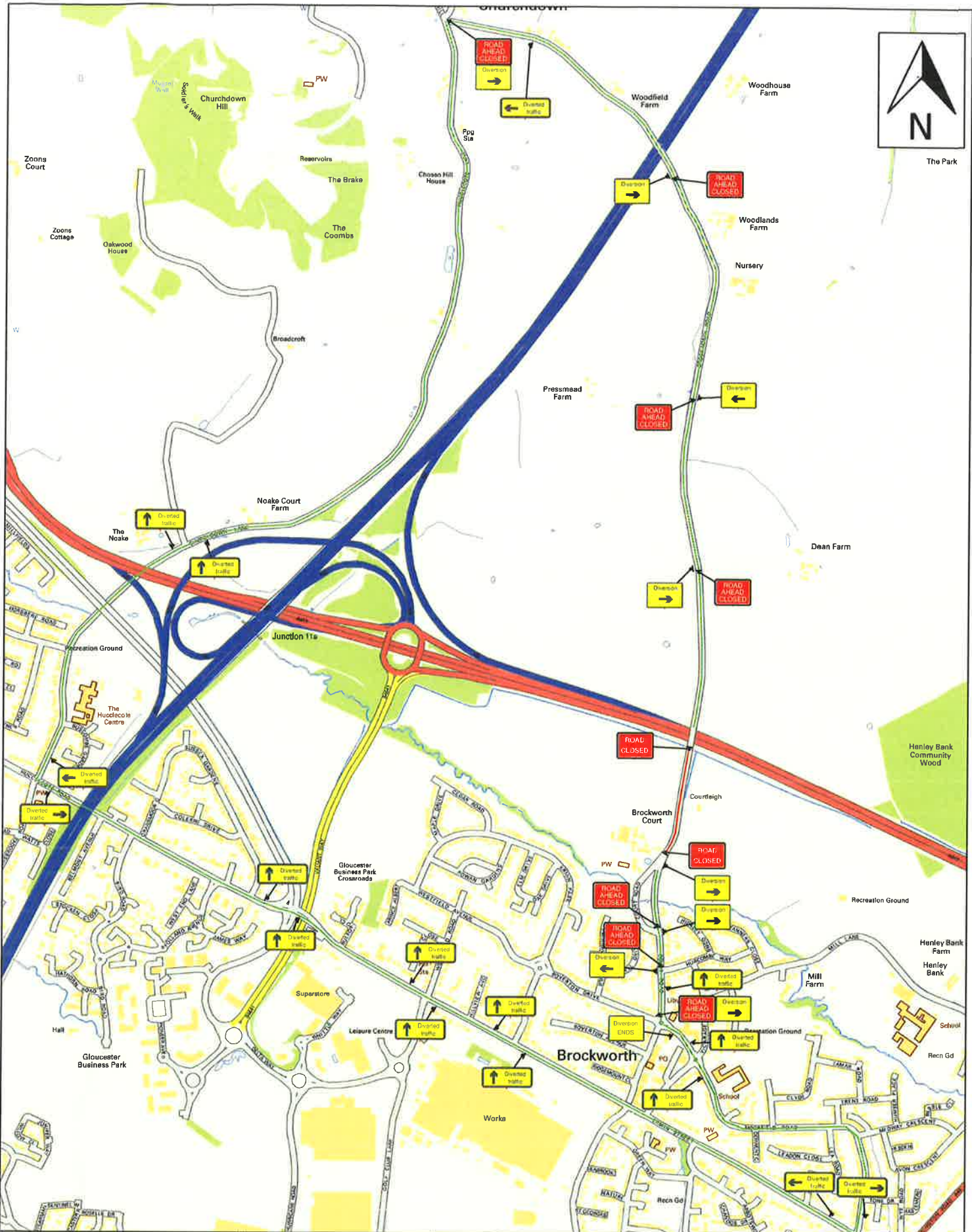

The Park



CAD Engineer: J.Smart
Customer: Triconnex
Contact: Purdy Payne
Location: Court Road, Brockworth, Gloucester, GL3 4QY
Date Drawn: 07/11/18
TM Method Statement: yes

Drawing Ref: CAD-JS-859

This Drawing is subject to Copyright and remains the property of Hooke Highways Ltd

Hooke Highways Traffic Management Ltd
Tel: 01934 733516
Email: orders@hookehighways.co.uk

Produced By: **J.S** Checked By: **J.T**

TRAFFIC MANAGEMENT NOTES:

- 1) All temporary traffic management shall be in accordance with Chapter 8 of the Traffic Signs Manual 2009 and Safety at Street Works and Road Works, A Code of Practice.
- 2) All temporary traffic management drawings remain the property of Hooke Highways Traffic Management.
- 3) All temporary traffic management works will be undertaken by an appropriately qualified operative registered under the NHSS (National Highways Sector Scheme)
- 4) Drawings are unsealed unless stated otherwise and are schematic only.

Key Chart:

	Road Sign
	Cones
	Works Area

